

******PLEASE READ CAREFULLY******

THE FOLLOWING ITEMS ARE NEEDED TO COMPLETE THIS APPLICATION:

- **A MAP OF THE PROPERTY TO BE EVALUATED**
- **10 DIGIT PARCEL NUMBER FOR PROPERTY**
This number can be obtained from Land Records Office, down the hall from this office, 2nd door down on right.
- **A PROPOSED SITE PLAN FOR PROPERTY**
You may use the attached site plan worksheet or submit your own. Please follow the instructions on the site plan worksheet and see sample site plan on last page of application. It is crucial that you be very specific about locations of structures, driveways, wells, etc. or we cannot properly evaluate your site.

For new system evaluations:

- Property must be cleared (mowed, bush-hogged, etc.) to permit easy access. This may require mowing tall weeds in a field or cutting bushes and limbing trees in a wooded area. If wooded lots are cleared, it is very important not to disturb existing soil or reshape lots in any way. Clearing with heavy equipment should only be done in dry conditions. Disturbance of soil may cause sites to be unsuitable for a septic system or may require a more expensive system. A permit that has been issued could be revoked due to site disturbance or construction in the area permitted for the septic system or repair area.
- Property corners must be flagged with provided yellow flags. All survey irons must be identified prior to calling for the site evaluation. If owner/agent cannot find irons, then a licensed surveyor should be hired by the owner/agent to identify irons.
- Property must be identified by a marker on the road frontage.
- Any designated wetlands must be identified prior to this evaluation. You are advised to check with Army Corps of Engineers at (252) 975-3025 and CAMA at (252)946-6481

For existing system evaluations:

- A portion of the septic tank must be uncovered. (1'x1'min.)
- A yellow flag must be placed at the septic tank and another at the driveway or road frontage to aid in locating the site.

For repair evaluations:

- Place a yellow flag at the septic tank and another at the driveway.
- Please indicate on the application what type of problem you are having. (backing up in house, in yard, at tank, etc.)

The septic system and any other improvements or conditions shall be installed and maintained as indicated on the permit issued. This permit shall in no way be taken as a guarantee or implied warranty that the septic system will function for any given period of time or that representatives of the Health Department assume any liability for related damages, consequential or direct, which are caused or which may be caused by a malfunctioning of such system.

All checks can be made Payable to: Beaufort County Health Department

****Once you have properly prepared the site for evaluation, contact Environmental Health at (252)946-6048 to inform us that your site is ready for inspection. If you do not call back, your site will not be scheduled for inspection****

Example Site Plan

This example was prepared to assist you in drawing your own site plan. Without your site plan we cannot perform the site evaluation. If you have any questions, please call us at (252) 946-6048

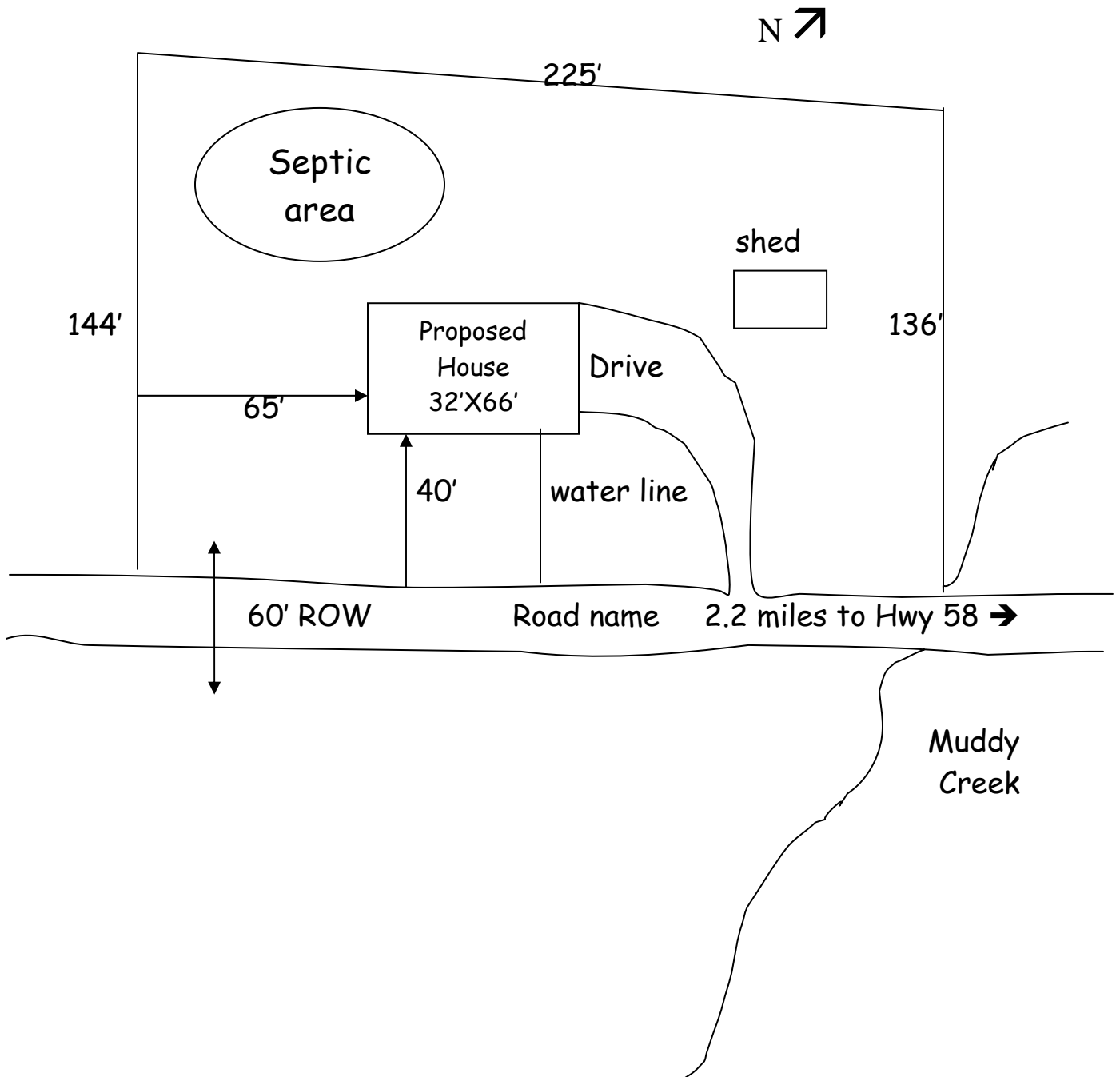

SITE PLAN WORKSHEET

Place a mark (X) beside each item that has been indicated on your site plan, incomplete site plans will be returned to you for completion. Remember: **Your property will not be scheduled for an evaluation until we have received a completed application, site plan, and all proposed items are marked on the property.**

- _____ - The dimensions of the property.
- _____ - The proposed location of all structures (e.g.: facility, wells, water lines, outbuildings, pools).
Show the distances from the road and the side property line to all structures. Be sure and give the dimensions for all the structures. If you are unsure as to the structure size, please show the dimensions of the MAXIMUM area of the lot that you anticipate the structure will cover.
- _____ - The site you would prefer your septic system to go in.
- _____ - The preferred driveway location.
- _____ - The proposed well location.
- _____ - A north arrow or other sufficient directional indicator.
- N/A _____ - Any proposed structures or improvements to the property such as garages, workshops, pools, etc.
If there are none, circle "N/A"
- N/A _____ - The location of any existing septic tank systems and wells on your property and on the adjoining property within 100' of your property line. **If there are none, circle "N/A"**.
- N/A _____ - The location of any easements or rights of way on the property. **If there are none, circle "N/A"**.
- N/A _____ - The location of any designated wetlands on the property. **If there are none, circle "N/A"**

USE THIS SPACE TO DRAW YOUR SITE PLAN: